

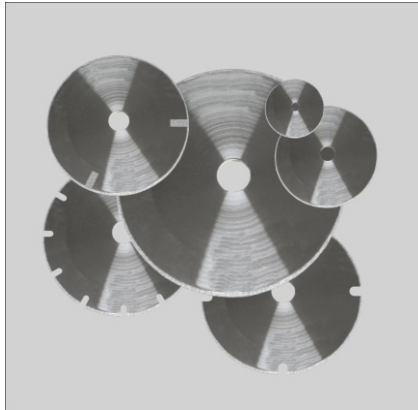

Gem Diamond Products

Electroplated Blades / Slitting Saws



- ❖ Used where aggressive cutting is required.
- ❖ Economical due to low cost, and high rate of production.
- ❖ Suitable for hand as well as machine operation.
- ❖ Unlike sintered saws, do not require cooling as exposed diamonds trap air which acts as coolant.
- ❖ Can be made in continuous or interrupted type with slots for further cooling
- ❖ Widely used for slitting graphite, printed circuit boards, fiber reinforced glass and plastic, green tungsten carbides, stones, precious and semi-precious stones, etc.

Specifications for Electrodeposited Diamond Slitting Discs

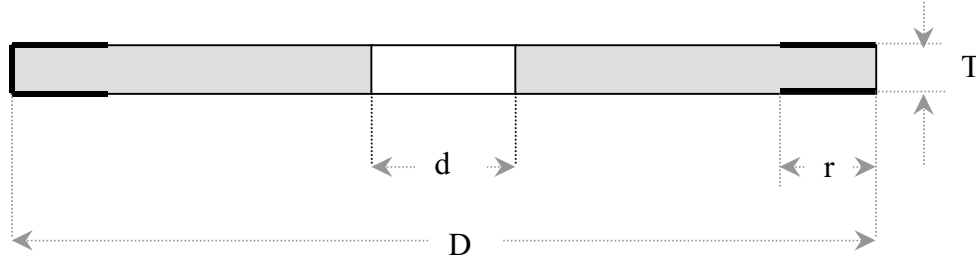

1. D Outer Diameter of the disc (Available from 1 inch to 36 inches)
2. d Bore / Arbor Diameter
3. T Thickness (specify blank thickness or coated thickness starting at 0.8mm)
4. r "Return" provided for diamond coating (Standard 3 mm return)
5. n Number of slots with dimensions (in the case of interrupted slitting discs)
6. G Grit Size of Diamond to be Used.

Standard Electrodeposited Diamond Slitting Discs

Continuous Rim Slitting Discs

Slotted Rim Slitting Discs

Without Pad

With Pad

Narrow Slots

Wide Slots.

